

The background is a solid blue color with a pattern of white, stylized circuit traces or lines that create a sense of depth and technology. The lines are arranged in a way that suggests a network or data flow, with some lines curving and others straight.

CCC[®] TOUCH INSTALLATION GUIDE

TABLE OF CONTENTS

| | |
|--|--------|
| Overview | Page 3 |
| Creating Microsoft Account | Page 4 |
| Adding Printers | Page 5 |
| Installing CCC [®] Touch from the Windows [®] Store..... | Page 7 |
| Starting CCC [®] Touch | Page 8 |

OVERVIEW

Installing CCC® Touch on your tablet is a short process. Each section has a set of procedures that you should complete. This installation guide explains how to install CCC® Touch on your tablet successfully.

Introduction

Creating a Microsoft Account

1

Adding Printers

2

Installing CCC® Touch from the Windows Store

3

Starting CCC® Touch

If you have any questions or need to contact CCC Technical Support, call (800) 637-8511.



A **Microsoft account** is **required** to install and access CCC® Touch. If you already have a Microsoft account, **sign in** and proceed to the next part: **Adding Printers**.

1 Go to account.microsoft.com.

2 Select **Sign In**.

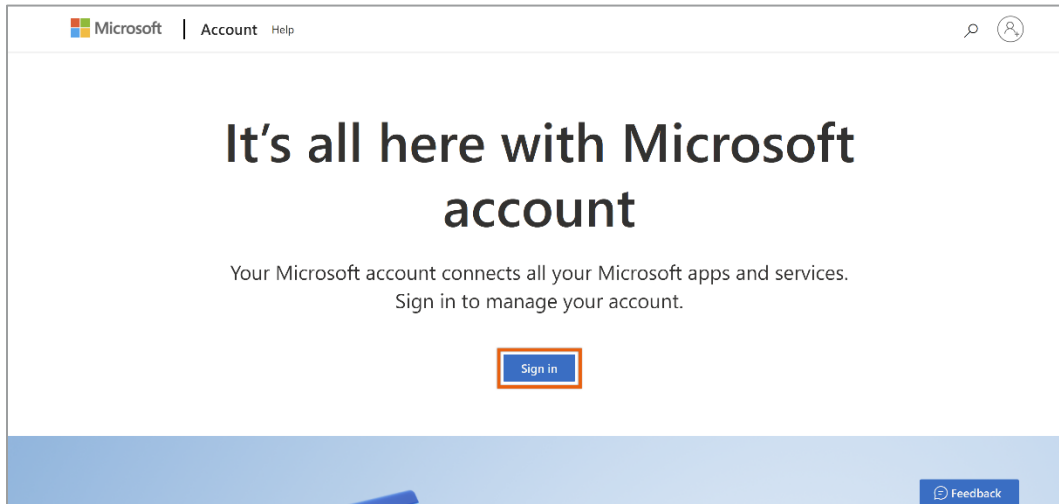

3 Select **Create one**.

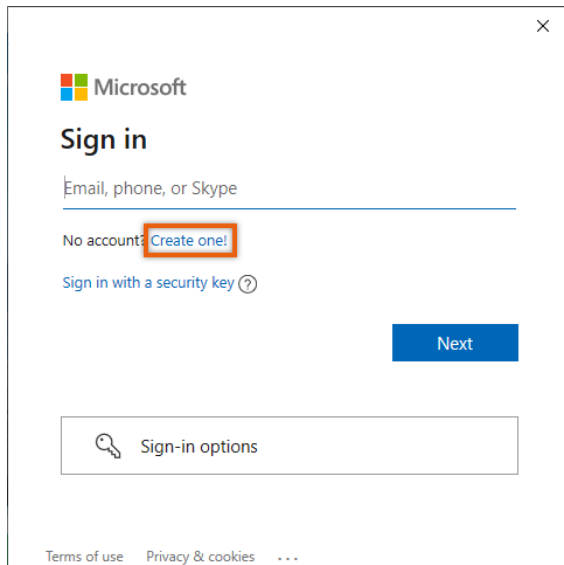



Adding Printers

1 To add a printer to your tablet, go to the **Start menu** and select the **Settings** icon.

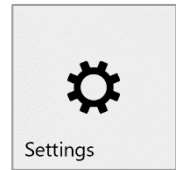

2 Select **Devices: Bluetooth, printers, mouse** from the **Windows Settings**.

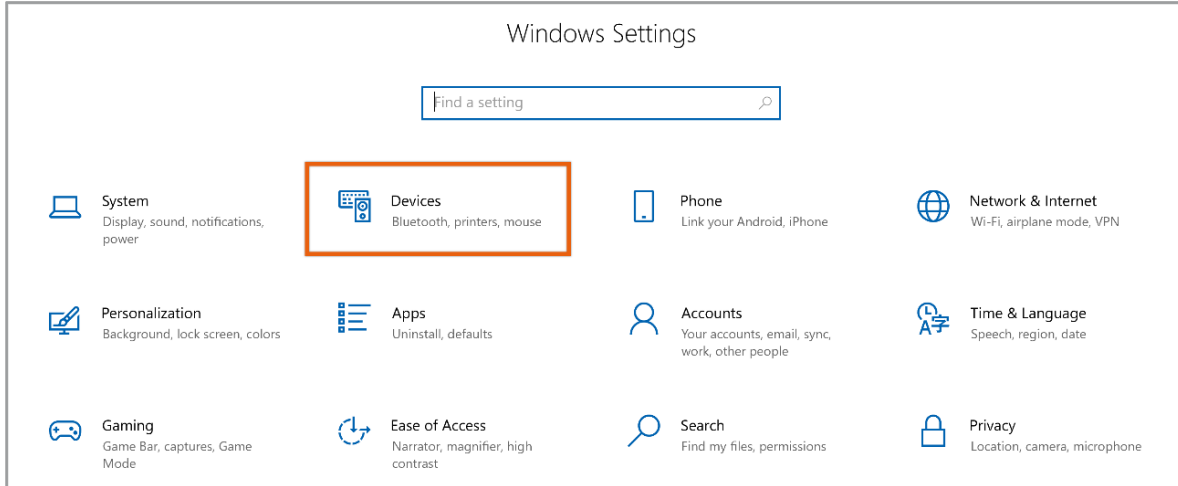

3 Select **Printers & scanners** from the **Devices** list.

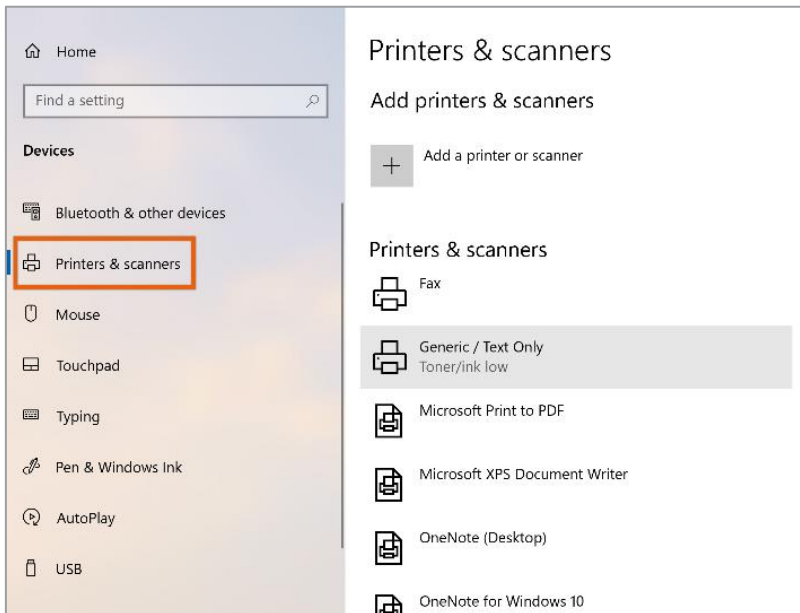



Adding Printers

4 Select **Add a printer or scanner**.

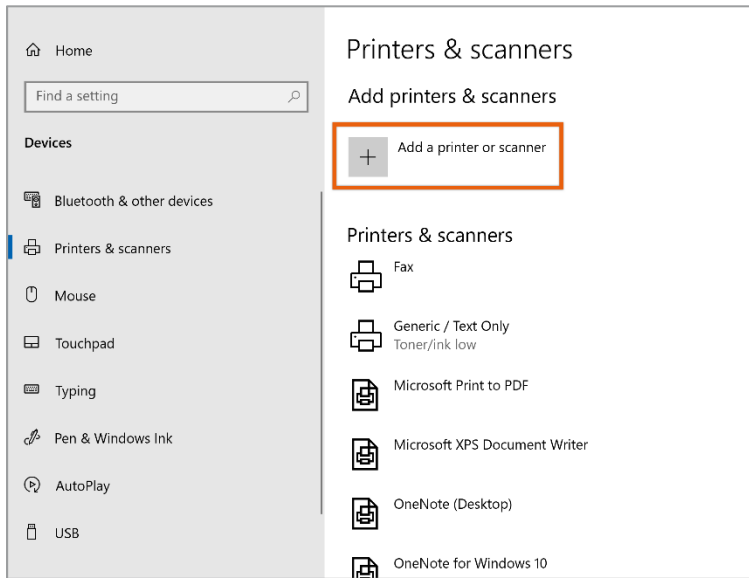

5 When the tablet searches for and displays all the **available** printers, select your printer by **tapping** it.

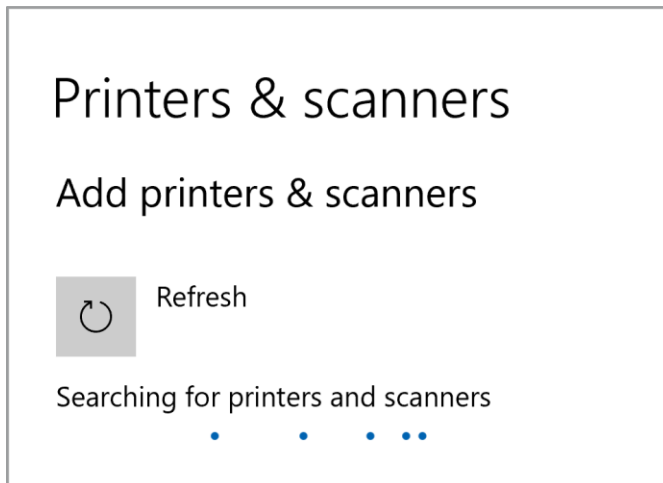



Installing CCC® Touch from the Windows® Store

- 1 Tap on the **Start menu icon** at the screen's bottom left corner to get back to the Windows Start menu.

- 2 Tap the shopping bag icon labeled **Microsoft Store**.

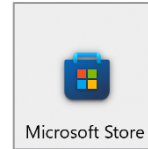

- 3 Enter **CCC ONE Touch** in the **search** field at the top right of the screen.

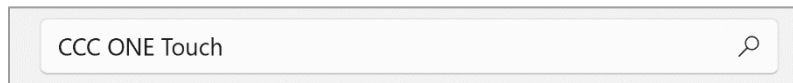

- 4 Select **Get** to install the application.

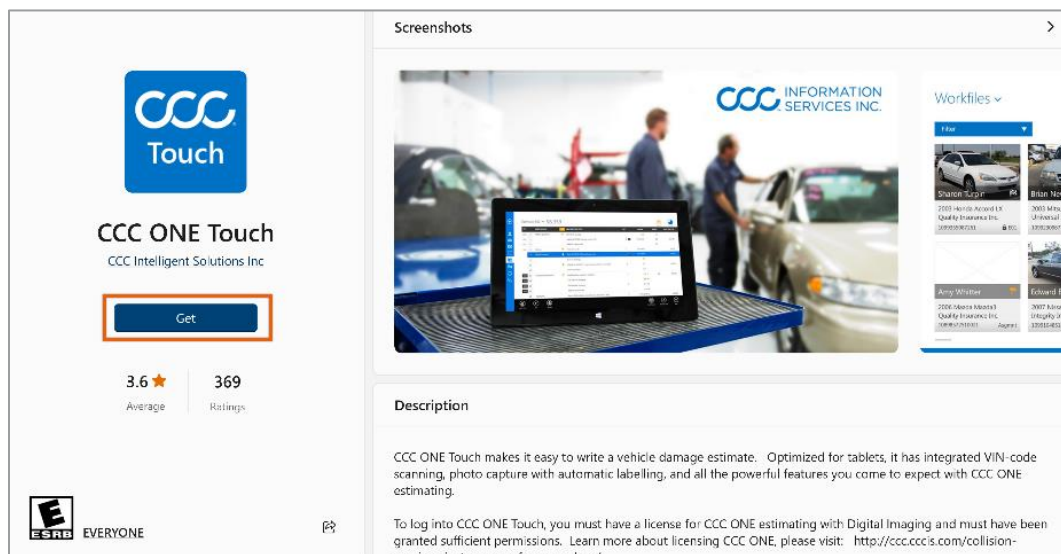

- 5 After installing the app, locate **CCC® Touch** in the **App Menu** by tapping the down arrow or swiping up from the bottom of the screen. **Touch** and **hold** the CCC® Touch icon and choose **Pin to Start** to add CCC® Touch to your default **Start menu**.





Starting CCC® Touch

- 1 Tap the **icon** to open CCC® Touch.



- 2 Select **Yes** or **No** to give CCC® Touch **access to your camera**. This can be changed within the **Windows Settings**.

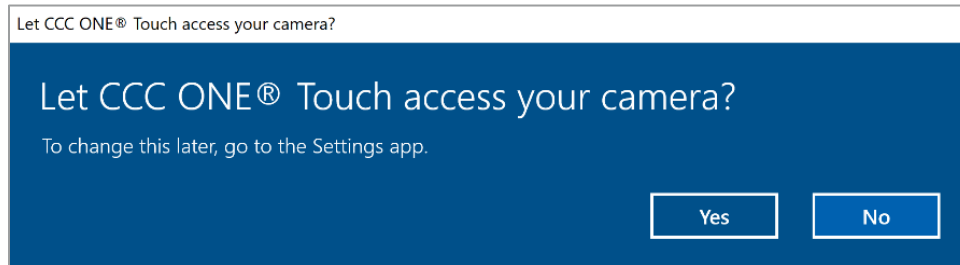

- 3 On the CCC® Touch sign-in screen, enter your CCC® **User Name** and **Password**. Use the same User Name and Password you use on the **desktop** version of CCC ONE®. Select **Login**.

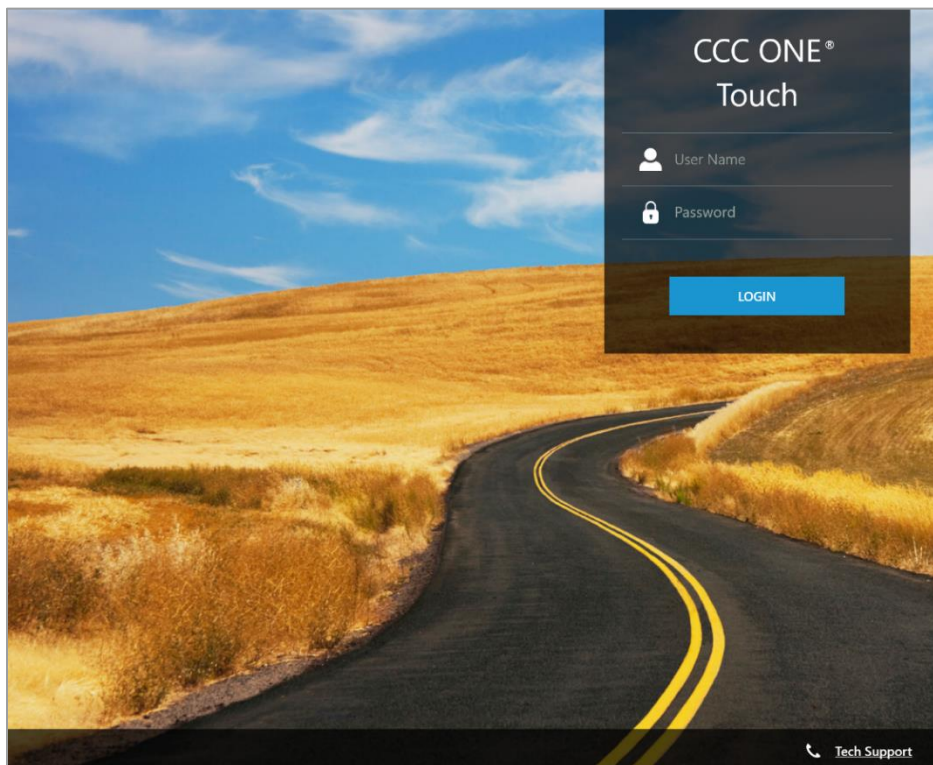



Starting CCC® Touch

- 4 Create a **4-digit PIN** to protect your account.

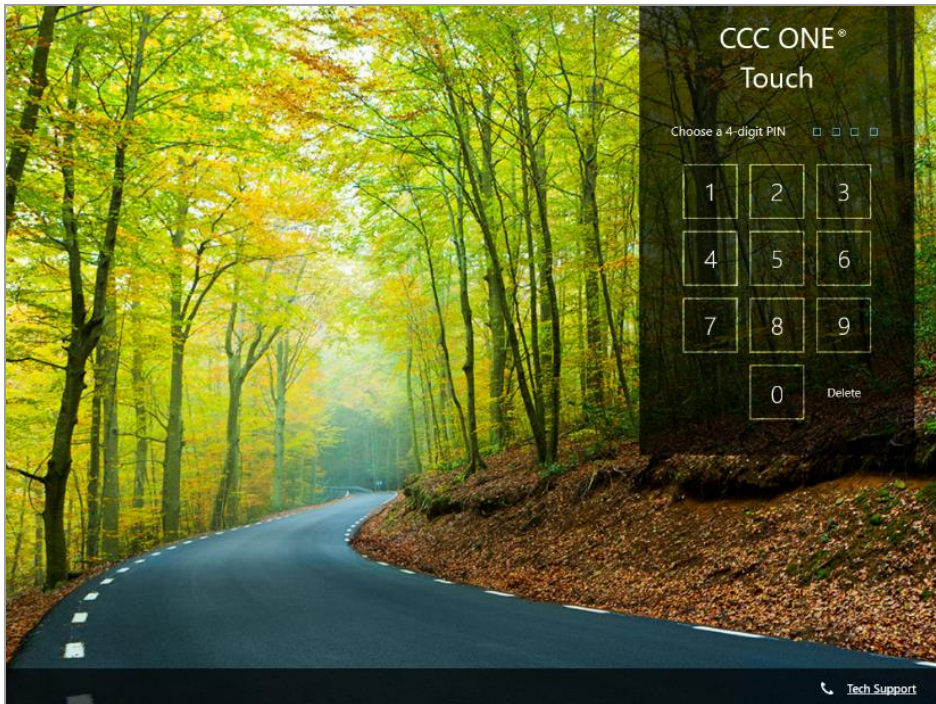

- 5 Read through the following **quick tour** slides.

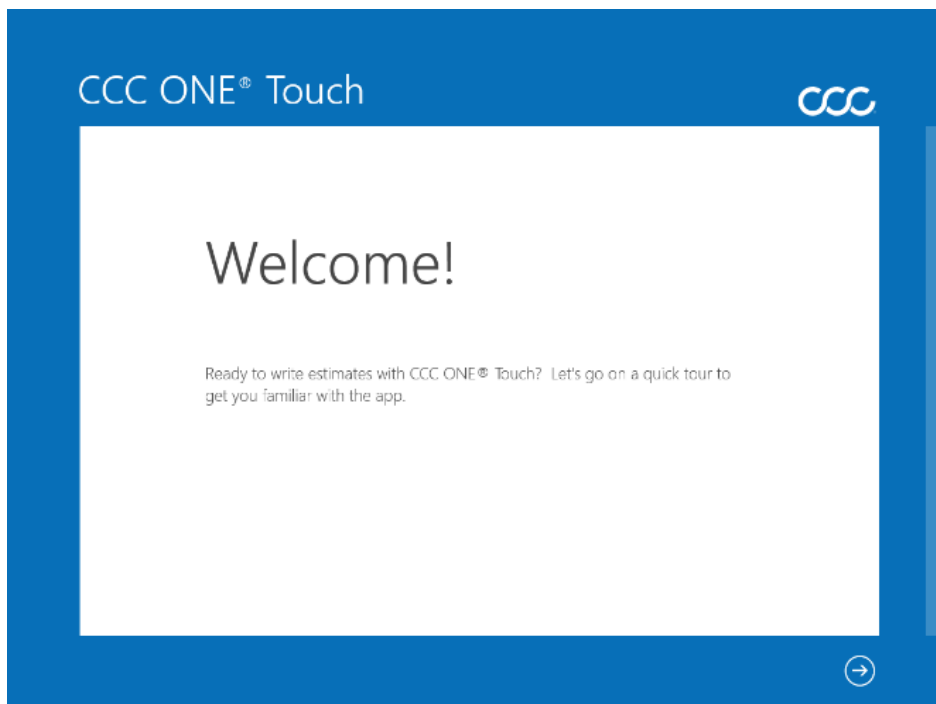



- 6 Your installation and setup are **complete**. You are ready to write estimates with CCC® Touch.

